

PA-2021-11600071
Z-2021-10700214

18.97 Acres

Legal Description

Lot P-102, NCB 10917

FROM:"I-1 H AHOD" General Industrial Historical Airport Hazard Overlay District and "I-1 AHOD" General Industrial Airport Hazard Overlay District.
TO: "IDZ-2 H AHOD" Medium Intensity Infill Development Zone Mission Historic Airport Hazard Overlay District with residential uses not to exceed 380 units and uses permitted in "C-2" Commercial District and "IDZ-2 AHOD" Medium Intensity Infill Development Zone Airport Hazard Overlay District with residential uses not to exceed 380 units and uses permitted in "C-2" Commercial District.

I, Julio Gonzalez, the property owner, acknowledge that this site plan submitted for the purpose of rezoning this property is in accordance with all applicable provisions of the Unified Development Code. Additionally, I understand that City Council apporval of a site plan in conjunction with a rezoning case does not relieve me from adherence to any/ all City adopted Codes at the time of plan submittal for building permits

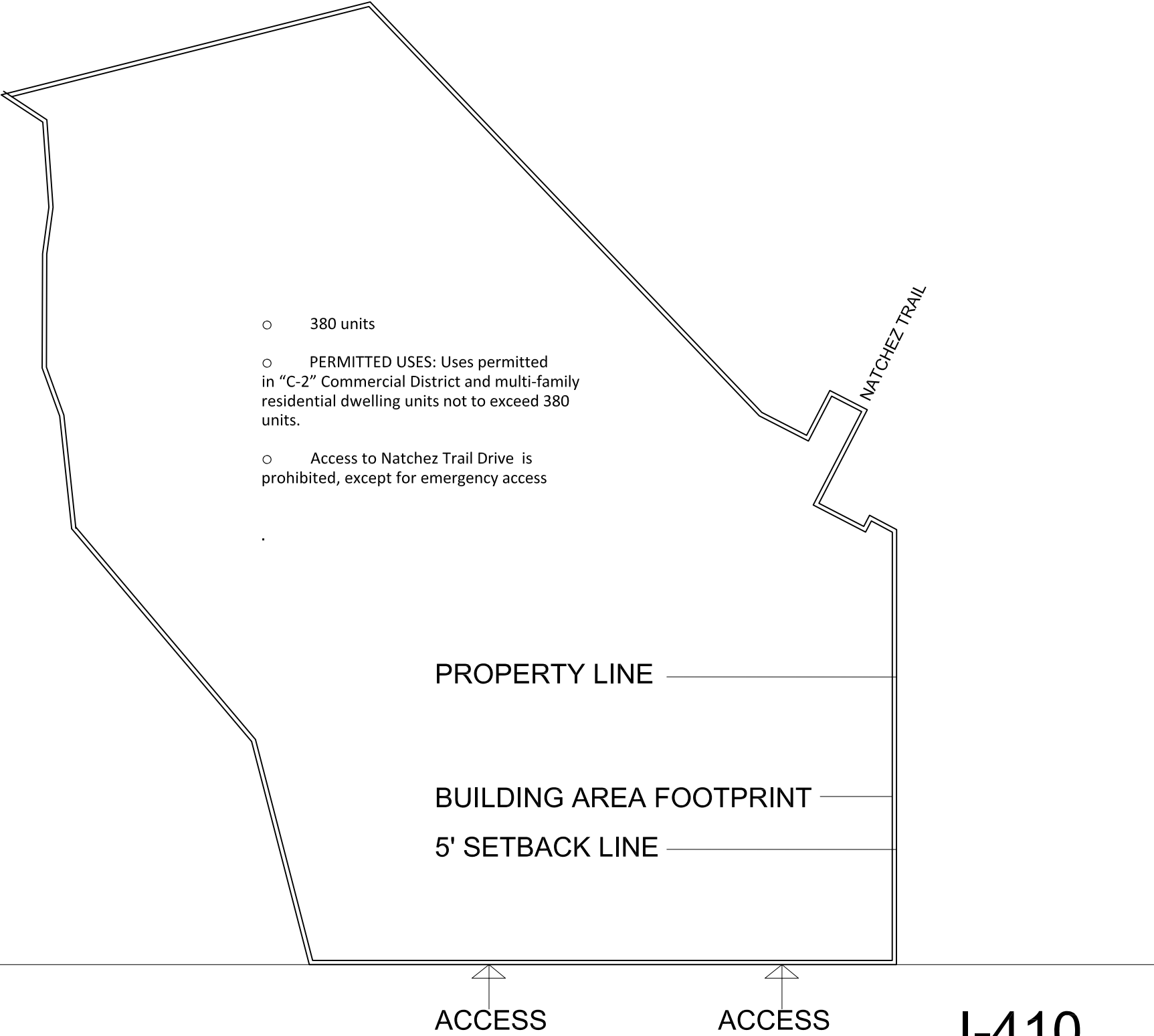

IDZ - 2 ZONING SITE PLAN

Exhibit A

Sabot Development

February 1st, 2022

1" = 200'